

Part Number: 1137

Type	Size	Rating	Description
Incandescent	T9	24V 2W	T-2¾ Bayonet Lamp

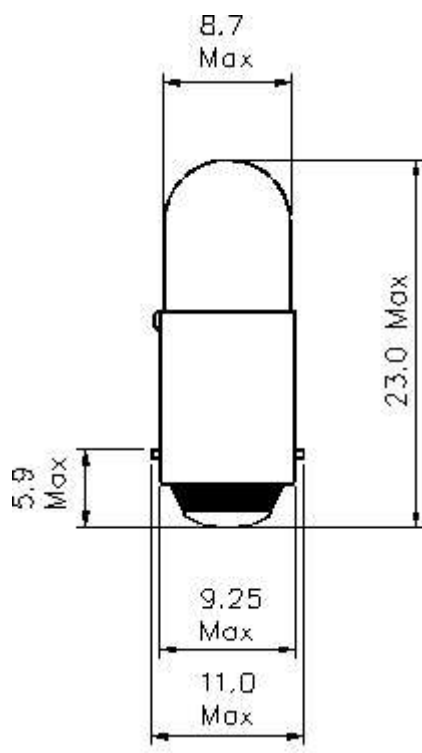

Dimensions in millimetres

TEST VOLTS	CURRENT (mA)			LIGHT OUTPUT (Lm)			LIFE Hours
	Min.	Nom.	Max.	Min.	Nom.	Max.	
24	72	80	88	4.7	6.3	7.9	10,000

Notes:

- 1 **Base Type** Nickel plated BA9s/13 base to BS EN 60061-1
- 2 **Filament Shape** C-2F
- 4 **Lamp Marking** CML 24V 2W engraved or ink stamped on base shell
- 5 **Environmental** RoHS & REACH SVHC compliant